

ONUK S56

TECHNICAL CHARACTERISTICS

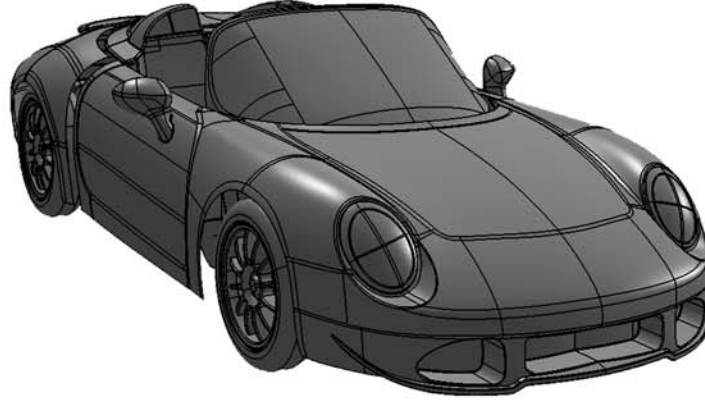

GENERAL DATA

CURB WEIGHT (KGS)	900
WEIGHT DISTRIBUTION (W/DRIVER)	45 / 55
WHEELBASE (MM)	2360
TRACK, FRONT / REAR (MM)	1460 / 1470
WIDTH (MM)	1750 (W/O MIRRORS), 1880 (W/ MIRRORS)
HEIGHT (MM)	1200
LENGTH, OVERALL (MM)	4200
GROUND CLEARANCE (MM)	130
TRUNK SPACE (DM ³)	135

ACCOMMODATIONS

SEATING CAPACITY	2
HEADROOM, FRONT/REAR	OPEN + HARD TOP
SEAT WIDTH, FRONT / REAR (MM)	360
LEG ROOM, FRONT SEAT (MM)	400 - 560
KNEE ROOM, REAR SEAT (MM)	NIL
SEATBACK ADJUSTMENT (MM)	NIL
SEAT TRAVEL (MM)	130

SAFETY

SEATBELTS
DUAL CIRCUIT BRAKE SYSTEM
ROLLBAR

ENGINE

MAKE / MODEL	FORD / 1.6L GTDI EcoBoost®
TYPE / LAYOUT	TRANSVERSAL MID ENGINE / REAR WHEEL DRIVE
NUMBER OF CYLINDERS / CONFIGURATION	4, IN LINE
DISPLACEMENT (CM ³)	1596
BORE X STROKE (MM)	79.0 x 81.4
VALVETRAIN	TWIN - INDEPENDENT VARIABLE-CAM TIMING (TI-VCT)
COMPRESSION RATIO	10.1 / 1
HORSEPOWER (KW / HP)	120 / 180 @6000 RPM
BHP/LITER	123
TORQUE (NM)	240 @1600-5000RPM

ENGINE (OPTION)

MAKE / MODEL	FORD 2.0 GTDI EcoBoost®
TYPE / LAYOUT	TRANSVERSAL MID ENGINE / REAR WHEEL DRIVE
NUMBER OF CYLINDERS / CONFIGURATION	4, IN LINE
DISPLACEMENT (CM ³)	1999
BORE X STROKE (MM)	87.5 x 83.1
VALVETRAIN	DUAL OVERHEAD CAMSHAFT, VVT
COMPRESSION RATIO	10.0 / 1
HORSEPOWER (KW / HP)	187 / 252@5500 RPM
BHP/LITER	126
TORQUE (NM)	373 @1500-4500 RPM

ONUK TAŞIT TASARIM VE ÜRETİM AŞ.
KIZILÇAM SOKAK 8, AYDINTEPE, TUZLA 34947 İSTANBUL/TÜRKİYE
TEL: +90 (216) 507 1076 - +90 (216) 392 9970 FAX: +90 (216) 507 1079 - +90 (216) 392 9969
WWW.ONUK.COM / INFO@ONUK.COM

ONUK S56

TECHNICAL CHARACTERISTICS

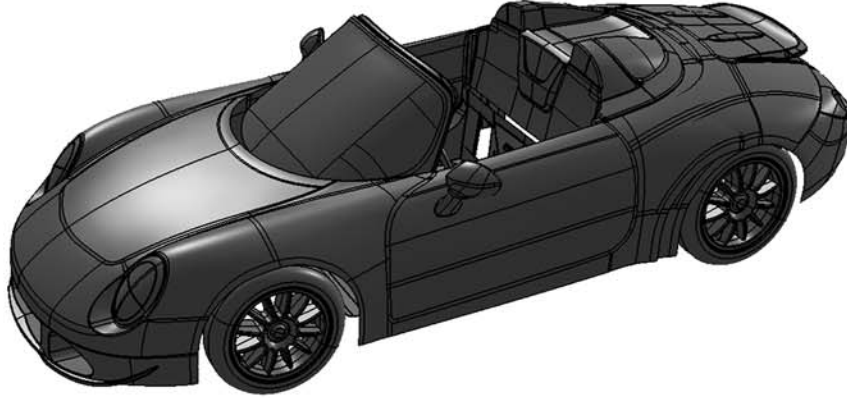

DRIVETRAIN

TRANSMISSION	6 SPEED MANUAL / FORD
1ST GEAR, RATIO	3.73
2ND GEAR, RATIO	2.05
3RD GEAR, RATIO	1.36
4TH GEAR, RATIO	1.03
5TH GEAR, RATIO	0.82
6TH GEAR RATIO	0.69
FINAL DRIVE RATIO	3.82

DRIVETRAIN (OPTION)

TRANSMISSION	6 SPEED MANUAL / FORD MMT6
1ST GEAR, RATIO	3.231
2ND GEAR, RATIO	1.952
3RD GEAR, RATIO	1.321
4TH GEAR, RATIO	1.029
5TH GEAR, RATIO	1.129
6TH GEAR RATIO	0.943
FINAL DRIVE RATIO	4.063 & 2.955

CHASSIS & BODY

LAYOUT	TRANSVERSE MID ENGINE, REAR WHEEL DRIVE
BODY / FRAME	COMPOSITE BODY, STEEL FRAME
BRAKES, FRONT	280MM VENTED DISCS, 1 PISTON SLIDING CALIPERS
BRAKES, REAR	280MM VENTED DISCS, 1 PISTON SLIDING CALIPERS
ASSIST TYPE	VACUUM
WHEELS, FRONT/REAR	16 X 7J / 17 X 7J
TIRES, FRONT	205/50 X 16
TIRES, REAR	225/55 X 17S
SPARE TIRE	SPACE SAVER
STEERING	RACK AND PINION
STEERING RATIO	16.8 / 1
STEERING WHEEL DIAMETER (MM)	320
URNS, LOCK TO LOCK	2.8
TURNING CIRCLE (MM)	9440
SUSPENSION, FRONT	DOUBLE WISHBONES, COIL OVER ADJUSTIBLE SHOCKS, ANTI-ROLL BAR
SUSPENSION, REAR	DOUBLE WISHBONES, COIL OVER ADJUSTIBLE SHOCKS, ANTI-ROLL BAR